

Non-DPS Employees DPSGuest Wireless Network

This guide is for individuals who **do not** have a DPS employee account, such as vendors, parents, and other non-DPS employees.

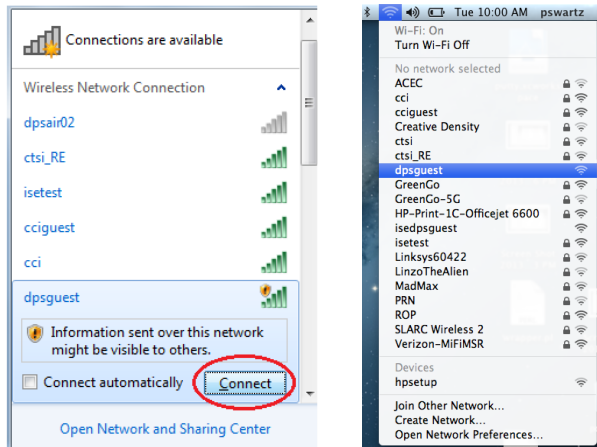

On a PC:

1. Access the list of available wireless connections.
2. Select the **dpsguest** network.
3. Click on **Connect**.

On a Mac:

1. Click on the wireless icon on the toolbar.
2. Select the **dpsguest** network.

The screenshot shows a web-based authentication form. At the top are fields for 'Username:' and 'Password:'. Below these is a large text block containing a disclaimer about the DPS internet system and network security. At the bottom of the text block is a checkbox labeled 'I agree to the terms and conditions'. Below the checkbox is a 'Sign On' button and a link that says 'Don't have an account?'.

Launch any web browser –

1. At the authentication screen, click on **Don't have an account?** at the bottom of the page.

The screenshot shows the 'DPS Guest Portal' with a 'Create Account' section. It prompts the user to 'Provide us with some information so we can create an account for you.' The form includes input fields for 'First name', 'Last name', 'Email address*', and 'Phone number*'. There is also a dropdown menu for 'SMS provider*' with 'ATT' selected. At the bottom are 'Register' and 'Cancel' buttons.

2. Complete the first name, last name, email, and phone number fields.
3. Select the appropriate SMS provider.
4. Click **Register**.

Non-DPS Employees DPSGuest Wireless Network

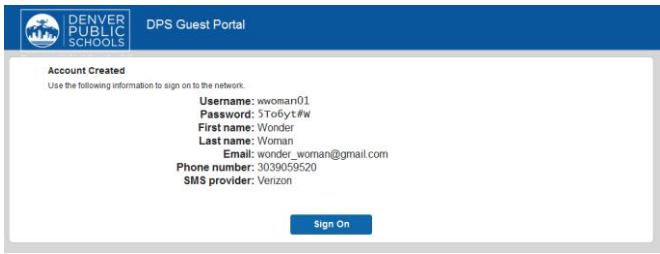
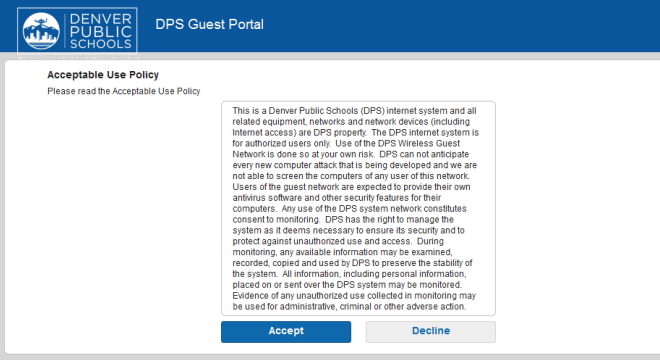
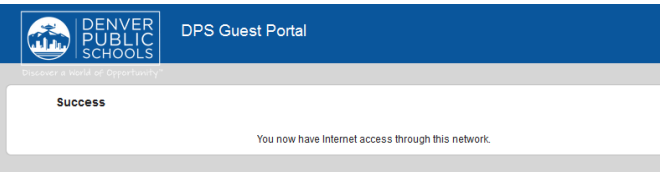
	<p>5. A username and password will be displayed, emailed, and a text will be sent to the phone number that was provided.</p> <p>6. Click Sign On.</p>
	<p>7. Click Accept at the Acceptable Use Policy for DPS.</p>
	<p>8. The device will have access to the DPS guest network.</p> <p>9. Enter any URL in the address bar.</p>